

In the City of Toronto in the Municipality of Metropolitan Toronto being composed of part of Lot 21, West side of Clinton Street according to a Plan filed in the Land Registry Office for the Registry Division of Metropolitan Toronto as No. 75 and designated as PARTS 15, 16, 17 and 18 on a Plan of Survey filed in the said Registry Office as No. 64R-15473.

RESERVING a right-of-way over, along and upon Part of said Lot 21, Plan 75 being PARTS 16, 17 and 18 on said Plan 64R-15473 in favour of the owners and occupants from time to time of Part of Lot 21, Plan 75 being PARTS 1 to 14 inclusive and 19 to 30 inclusive, Plan 64R-15473 for the purpose of ingress and egress.

TOGETHER WITH a right-of-way over, along and upon Part of Lot 21, Plan 75 being PARTS 2, 4, 6, 8, 10, 12, 14, 19, 20, 24, 25, 26, 27, 28 and 29 on said Plan 64R-15473 for the purpose of ingress and egress.

**PLAN GAR-15**

DATE: 02.05.09

SCALE: 1:100

PROJECT: PART OF LOT 21, WEST SIDE OF CLINTON STREET, REGISTERED PLAN 75, CITY OF TORONTO, MUNICIPALITY OF METROPOLITAN TORONTO

DATE: 02.05.09

SCALE: 1:100

PROJECT: PART OF LOT 21, WEST SIDE OF CLINTON STREET, REGISTERED PLAN 75, CITY OF TORONTO, MUNICIPALITY OF METROPOLITAN TORONTO

**METRIC**

ALL DIMENSIONS ON THIS PLAN ARE IN METERS AND MILLIMETERS UNLESS OTHERWISE SPECIFIED.

**PLAN OF SURVEY OF PART OF LOT 21, WEST SIDE OF CLINTON STREET, REGISTERED PLAN 75, CITY OF TORONTO, MUNICIPALITY OF METROPOLITAN TORONTO**

SCALE: 1:100

DATE: 02.05.09

**LEGEND**

0 = BOUNDARY LINE

1 = EXISTING CONCRETE DRIVE

2 = EXISTING ASPHALT DRIVE

3 = EXISTING GRAVEL DRIVE

4 = EXISTING GRAVEL DRIVE

5 = EXISTING GRAVEL DRIVE

6 = EXISTING GRAVEL DRIVE

7 = EXISTING GRAVEL DRIVE

8 = EXISTING GRAVEL DRIVE

9 = EXISTING GRAVEL DRIVE

10 = EXISTING GRAVEL DRIVE

11 = EXISTING GRAVEL DRIVE

12 = EXISTING GRAVEL DRIVE

13 = EXISTING GRAVEL DRIVE

14 = EXISTING GRAVEL DRIVE

15 = EXISTING GRAVEL DRIVE

16 = EXISTING GRAVEL DRIVE

17 = EXISTING GRAVEL DRIVE

18 = EXISTING GRAVEL DRIVE

19 = EXISTING GRAVEL DRIVE

20 = EXISTING GRAVEL DRIVE

21 = EXISTING GRAVEL DRIVE

22 = EXISTING GRAVEL DRIVE

23 = EXISTING GRAVEL DRIVE

24 = EXISTING GRAVEL DRIVE

25 = EXISTING GRAVEL DRIVE

26 = EXISTING GRAVEL DRIVE

27 = EXISTING GRAVEL DRIVE

28 = EXISTING GRAVEL DRIVE

29 = EXISTING GRAVEL DRIVE

30 = EXISTING GRAVEL DRIVE

31 = EXISTING GRAVEL DRIVE

32 = EXISTING GRAVEL DRIVE

33 = EXISTING GRAVEL DRIVE

34 = EXISTING GRAVEL DRIVE

35 = EXISTING GRAVEL DRIVE

36 = EXISTING GRAVEL DRIVE

37 = EXISTING GRAVEL DRIVE

38 = EXISTING GRAVEL DRIVE

39 = EXISTING GRAVEL DRIVE

40 = EXISTING GRAVEL DRIVE

41 = EXISTING GRAVEL DRIVE

42 = EXISTING GRAVEL DRIVE

43 = EXISTING GRAVEL DRIVE

44 = EXISTING GRAVEL DRIVE

45 = EXISTING GRAVEL DRIVE

46 = EXISTING GRAVEL DRIVE

47 = EXISTING GRAVEL DRIVE

48 = EXISTING GRAVEL DRIVE

49 = EXISTING GRAVEL DRIVE

50 = EXISTING GRAVEL DRIVE

51 = EXISTING GRAVEL DRIVE

52 = EXISTING GRAVEL DRIVE

53 = EXISTING GRAVEL DRIVE

54 = EXISTING GRAVEL DRIVE

55 = EXISTING GRAVEL DRIVE

56 = EXISTING GRAVEL DRIVE

57 = EXISTING GRAVEL DRIVE

58 = EXISTING GRAVEL DRIVE

59 = EXISTING GRAVEL DRIVE

60 = EXISTING GRAVEL DRIVE

61 = EXISTING GRAVEL DRIVE

62 = EXISTING GRAVEL DRIVE

63 = EXISTING GRAVEL DRIVE

64 = EXISTING GRAVEL DRIVE

65 = EXISTING GRAVEL DRIVE

66 = EXISTING GRAVEL DRIVE

67 = EXISTING GRAVEL DRIVE

68 = EXISTING GRAVEL DRIVE

69 = EXISTING GRAVEL DRIVE

70 = EXISTING GRAVEL DRIVE

71 = EXISTING GRAVEL DRIVE

72 = EXISTING GRAVEL DRIVE

73 = EXISTING GRAVEL DRIVE

74 = EXISTING GRAVEL DRIVE

75 = EXISTING GRAVEL DRIVE

76 = EXISTING GRAVEL DRIVE

77 = EXISTING GRAVEL DRIVE

78 = EXISTING GRAVEL DRIVE

79 = EXISTING GRAVEL DRIVE

80 = EXISTING GRAVEL DRIVE

81 = EXISTING GRAVEL DRIVE

82 = EXISTING GRAVEL DRIVE

83 = EXISTING GRAVEL DRIVE

84 = EXISTING GRAVEL DRIVE

85 = EXISTING GRAVEL DRIVE

86 = EXISTING GRAVEL DRIVE

87 = EXISTING GRAVEL DRIVE

88 = EXISTING GRAVEL DRIVE

89 = EXISTING GRAVEL DRIVE

90 = EXISTING GRAVEL DRIVE

91 = EXISTING GRAVEL DRIVE

92 = EXISTING GRAVEL DRIVE

93 = EXISTING GRAVEL DRIVE

94 = EXISTING GRAVEL DRIVE

95 = EXISTING GRAVEL DRIVE

96 = EXISTING GRAVEL DRIVE

97 = EXISTING GRAVEL DRIVE

98 = EXISTING GRAVEL DRIVE

99 = EXISTING GRAVEL DRIVE

100 = EXISTING GRAVEL DRIVE

**HEARING NOTE**

THE HEARING WAS HELD AT THE OFFICE OF THE SURVEYOR, 100 BAY STREET, TORONTO, ONTARIO, M5H 2S4, ON 02.05.09 AT 10:00 AM. THE HEARING WAS OPEN TO THE PUBLIC AND THE RECORDING WAS MADE BY THE SURVEYOR.

**SURVEYOR'S CERTIFICATE**

I, THE SURVEYOR, HEREBY CERTIFY THAT THE INFORMATION CONTAINED IN THIS PLAN IS TRUE AND CORRECT TO THE BEST OF MY KNOWLEDGE AND BELIEF.

DATE: 02.05.09

SCALE: 1:100

PROJECT: PART OF LOT 21, WEST SIDE OF CLINTON STREET, REGISTERED PLAN 75, CITY OF TORONTO, MUNICIPALITY OF METROPOLITAN TORONTO

DATE: 02.05.09

SCALE: 1:100

PROJECT: PART OF LOT 21, WEST SIDE OF CLINTON STREET, REGISTERED PLAN 75, CITY OF TORONTO, MUNICIPALITY OF METROPOLITAN TORONTO



**L. MURPHY & ESTER LTD.**

100 BAY STREET, TORONTO, ONTARIO, M5H 2S4

DATE: 02.05.09

SCALE: 1:100

PROJECT: PART OF LOT 21, WEST SIDE OF CLINTON STREET, REGISTERED PLAN 75, CITY OF TORONTO, MUNICIPALITY OF METROPOLITAN TORONTO

**CO. OF GARMENTS - 02.05.09**

NO.	DESCRIPTION	QTY.	UNIT PRICE	TOTAL
1	...	...	...	...
2	...	...	...	...
3	...	...	...	...
4	...	...	...	...
5	...	...	...	...
6	...	...	...	...
7	...	...	...	...
8	...	...	...	...
9	...	...	...	...
10	...	...	...	...
11	...	...	...	...
12	...	...	...	...
13	...	...	...	...
14	...	...	...	...
15	...	...	...	...
16	...	...	...	...
17	...	...	...	...
18	...	...	...	...
19	...	...	...	...
20	...	...	...	...
21	...	...	...	...
22	...	...	...	...
23	...	...	...	...
24	...	...	...	...
25	...	...	...	...
26	...	...	...	...
27	...	...	...	...
28	...	...	...	...
29	...	...	...	...
30	...	...	...	...
31	...	...	...	...
32	...	...	...	...
33	...	...	...	...
34	...	...	...	...
35	...	...	...	...
36	...	...	...	...
37	...	...	...	...
38	...	...	...	...
39	...	...	...	...
40	...	...	...	...
41	...	...	...	...
42	...	...	...	...
43	...	...	...	...
44	...	...	...	...
45	...	...	...	...
46	...	...	...	...
47	...	...	...	...
48	...	...	...	...
49	...	...	...	...
50	...	...	...	...
51	...	...	...	...
52	...	...	...	...
53	...	...	...	...
54	...	...	...	...
55	...	...	...	...
56	...	...	...	...
57	...	...	...	...
58	...	...	...	...
59	...	...	...	...
60	...	...	...	...
61	...	...	...	...
62	...	...	...	...
63	...	...	...	...
64	...	...	...	...
65	...	...	...	...
66	...	...	...	...
67	...	...	...	...
68	...	...	...	...
69	...	...	...	...
70	...	...	...	...
71	...	...	...	...
72	...	...	...	...
73	...	...	...	...
74	...	...	...	...
75	...	...	...	...
76	...	...	...	...
77	...	...	...	...
78	...	...	...	...
79	...	...	...	...
80	...	...	...	...
81	...	...	...	...
82	...	...	...	...
83	...	...	...	...
84	...	...	...	...
85	...	...	...	...
86	...	...	...	...
87	...	...	...	...
88	...	...	...	...
89	...	...	...	...
90	...	...	...	...
91	...	...	...	...
92	...	...	...	...
93	...	...	...	...
94	...	...	...	...
95	...	...	...	...
96	...	...	...	...
97	...	...	...	...
98	...	...	...	...
99	...	...	...	...
100	...	...	...	...



**NOTE**

1. THE SURVEYOR HAS CONDUCTED A VISUAL INSPECTION OF THE SITE AND HAS FOUND THAT THE INFORMATION CONTAINED IN THIS PLAN IS TRUE AND CORRECT TO THE BEST OF HIS KNOWLEDGE AND BELIEF.

2. THE SURVEYOR HAS CONDUCTED A VISUAL INSPECTION OF THE SITE AND HAS FOUND THAT THE INFORMATION CONTAINED IN THIS PLAN IS TRUE AND CORRECT TO THE BEST OF HIS KNOWLEDGE AND BELIEF.

3. THE SURVEYOR HAS CONDUCTED A VISUAL INSPECTION OF THE SITE AND HAS FOUND THAT THE INFORMATION CONTAINED IN THIS PLAN IS TRUE AND CORRECT TO THE BEST OF HIS KNOWLEDGE AND BELIEF.

4. THE SURVEYOR HAS CONDUCTED A VISUAL INSPECTION OF THE SITE AND HAS FOUND THAT THE INFORMATION CONTAINED IN THIS PLAN IS TRUE AND CORRECT TO THE BEST OF HIS KNOWLEDGE AND BELIEF.

5. THE SURVEYOR HAS CONDUCTED A VISUAL INSPECTION OF THE SITE AND HAS FOUND THAT THE INFORMATION CONTAINED IN THIS PLAN IS TRUE AND CORRECT TO THE BEST OF HIS KNOWLEDGE AND BELIEF.

6. THE SURVEYOR HAS CONDUCTED A VISUAL INSPECTION OF THE SITE AND HAS FOUND THAT THE INFORMATION CONTAINED IN THIS PLAN IS TRUE AND CORRECT TO THE BEST OF HIS KNOWLEDGE AND BELIEF.

7. THE SURVEYOR HAS CONDUCTED A VISUAL INSPECTION OF THE SITE AND HAS FOUND THAT THE INFORMATION CONTAINED IN THIS PLAN IS TRUE AND CORRECT TO THE BEST OF HIS KNOWLEDGE AND BELIEF.

8. THE SURVEYOR HAS CONDUCTED A VISUAL INSPECTION OF THE SITE AND HAS FOUND THAT THE INFORMATION CONTAINED IN THIS PLAN IS TRUE AND CORRECT TO THE BEST OF HIS KNOWLEDGE AND BELIEF.

9. THE SURVEYOR HAS CONDUCTED A VISUAL INSPECTION OF THE SITE AND HAS FOUND THAT THE INFORMATION CONTAINED IN THIS PLAN IS TRUE AND CORRECT TO THE BEST OF HIS KNOWLEDGE AND BELIEF.

10. THE SURVEYOR HAS CONDUCTED A VISUAL INSPECTION OF THE SITE AND HAS FOUND THAT THE INFORMATION CONTAINED IN THIS PLAN IS TRUE AND CORRECT TO THE BEST OF HIS KNOWLEDGE AND BELIEF.

**SCHEDULE**

NO.	DESCRIPTION	QTY.	UNIT PRICE	TOTAL
1	...	...	...	...
2	...	...	...	...
3	...	...	...	...
4	...	...	...	...
5	...	...	...	...
6	...	...	...	...
7	...	...	...	...
8	...	...	...	...
9	...	...	...	...
10	...	...	...	...
11	...	...	...	...
12	...	...	...	...
13	...	...	...	...
14	...	...	...	...
15	...	...	...	...
16	...	...	...	...
17	...	...	...	...
18	...	...	...	...
19	...	...	...	...
20	...	...	...	...
21	...	...	...	...
22	...	...	...	...
23	...	...	...	...
24	...	...	...	...
25	...	...	...	...
26	...	...	...	...
27	...	...	...	...
28	...	...	...	...
29	...	...	...	...
30	...	...	...	...
31	...	...	...	...
32	...	...	...	...
33	...	...	...	...
34	...	...	...	...
35	...	...	...	...
36	...	...	...	...
37	...	...	...	...
38	...	...	...	...
39	...	...	...	...
40	...	...	...	...
41	...	...	...	...
42	...	...	...	...
43	...	...	...	...
44	...	...	...	...
45	...	...	...	...
46	...	...	...	...
47	...	...	...	...
48	...	...	...	...
49	...	...	...	...
50	...	...	...	...
51	...	...	...	...
52	...	...	...	...
53	...	...	...	...
54	...	...	...	...
55	...	...	...	...
56	...	...	...	...
57	...	...	...	...
58	...	...	...	...
59	...	...	...	...
60	...	...	...	...
61	...	...	...	...
62	...	...	...	...
63	...	...	...	...
64	...	...	...	...
65	...	...	...	...
66	...	...	...	...
67	...	...	...	...
68	...	...	...	...
69	...	...	...	...
70	...	...	...	...
71	...	...	...	...
72	...	...	...	...
73	...	...	...	...
74	...	...	...	...
75	...	...	...	...
76	...	...	...	...
77	...	...	...	...
78	...	...	...	...
79	...	...	...	...
80	...	...	...	...
81	...	...	...	...
82	...	...	...	...
83	...	...	...	...
84	...	...	...	...
85	...	...	...	...
86	...	...	...	...
87	...	...	...	...
88	...	...	...	...
89	...	...	...	...
90	...	...	...	...
91	...	...	...	...
92	...	...	...	...
93	...	...	...	...
94	...	...	...	...
95	...	...	...	...
96	...	...	...	...
97	...	...	...	...
98	...	...	...	...
99	...	...	...	...
100	...	...	...	...

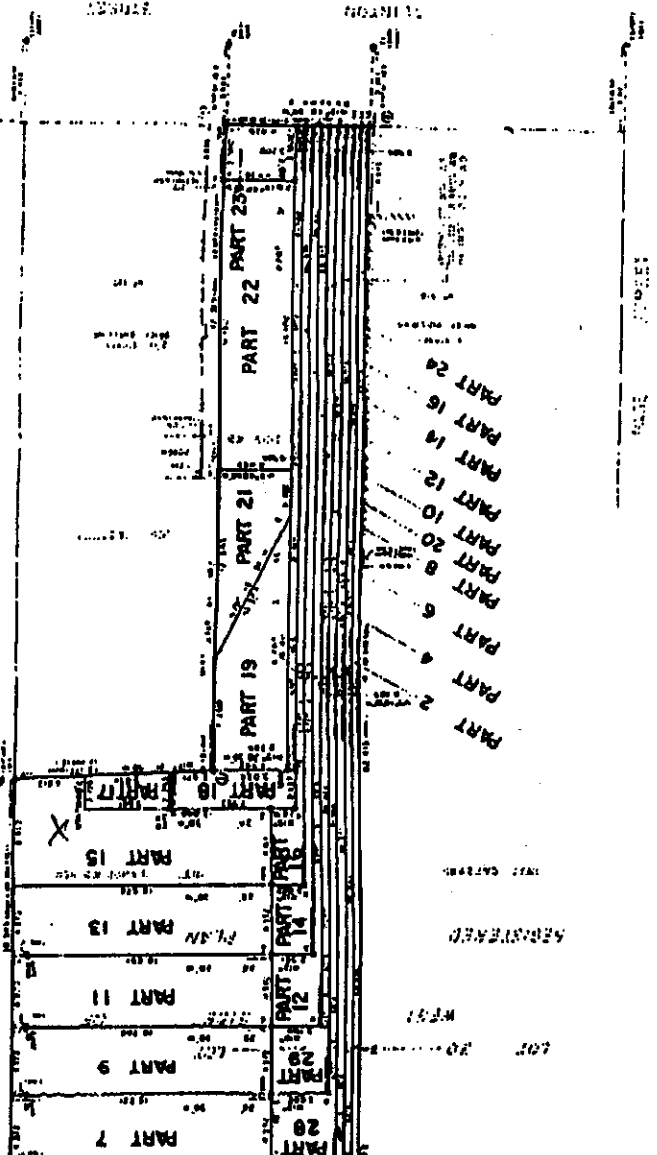

*[Handwritten signature]*

*[Handwritten signature]*