

PLAN OF SURVEY OF  
PART OF LOT 25  
CONCESSION 2, FROM THE BAY  
CITY OF TORONTO

PE-8175

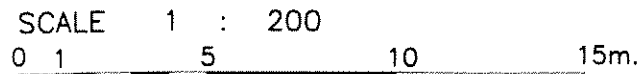

H. PILLER CORPORATION LTD.

BRUNSWICK AVENUE  
BY REGISTERED PLAN 191  
PIN 21230-0037 (1.1)

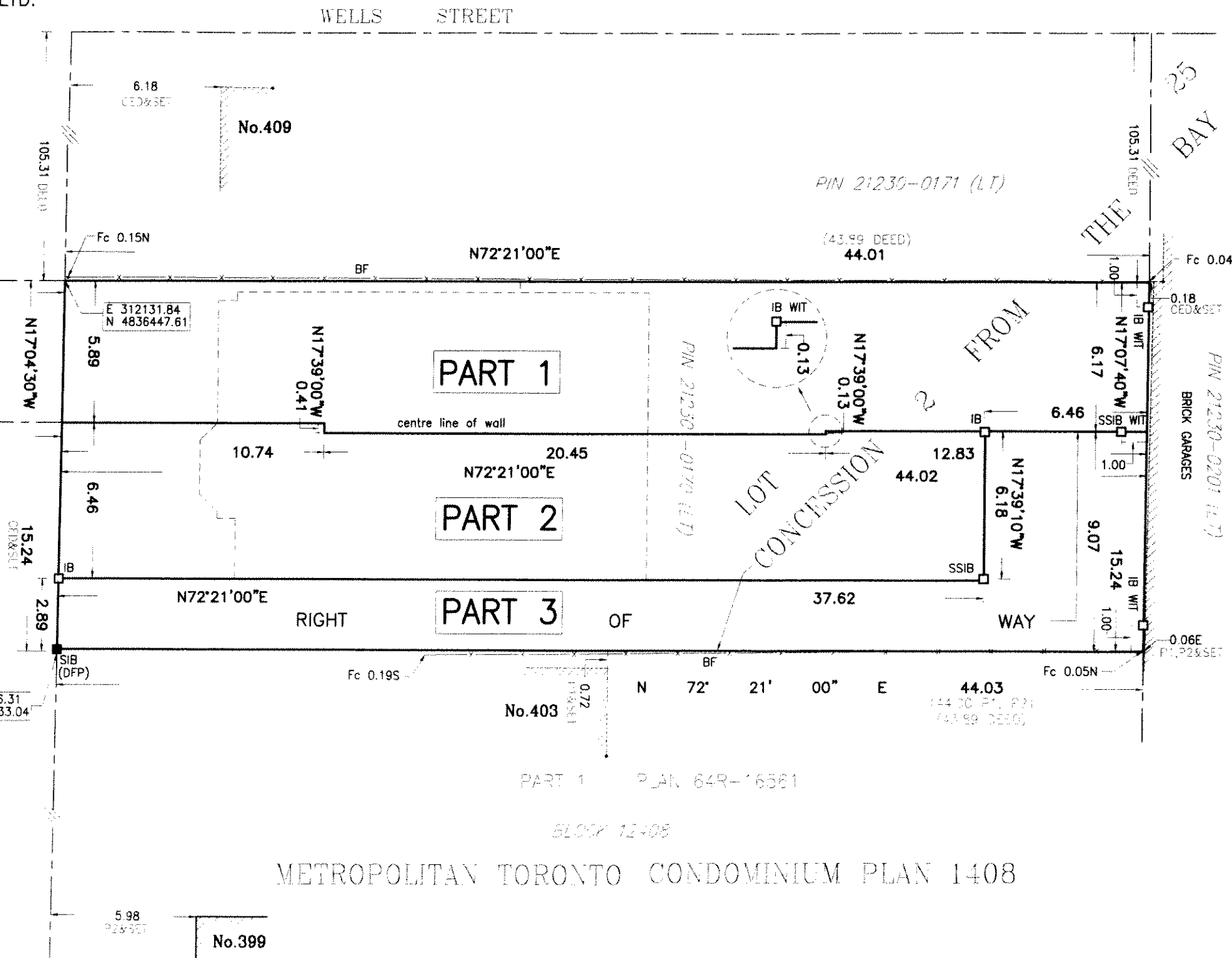

METROPOLITAN TORONTO CONDOMINIUM PLAN 1408

I REQUIRE THIS PLAN TO BE  
DEPOSITED UNDER THE  
LAND TITLES ACT.

PLAN 66R-23970

DATE: 25 SEP. 2008

DATE: OCTOBER 7, 2008

*Helmut Piller*  
Helmut Piller  
Ontario Land Surveyor

*"GALINA KISLANSKI"*  
DEPUTY LAND REGISTRAR FOR THE  
LAND TITLES DIVISION OF THE TORONTO  
REGISTRY OFFICE No. 66.

SCHEDULE

PART	PART OF LOT	CONCESSION	ALL OF PIN	AREA (m <sup>2</sup> )
1				271.2
2	25	2, FROM THE BAY	21230-0170 (LT)	232.6
3				167.0

BEARING NOTE :

Bearings hereon are grid bearings and are derived from horizontal control monuments no. 02019660311 (E312680.420, N4836795.670) and 02019660302 (E312594.130, N4836567.130) and are referred to the central meridian 79°30' west longitude, zone 10.

LEGEND :

■	Monument found	Fc	Fence
□	Monument planted	CLF	Chain link fence
CC	Cut Cross	BF	Board fence
IB	Iron Bar	DEED	Inst. No. CT 79107B
SSIB	Short Standard Iron Bar	CED	C. E. Dotterill, O.L.S.
SIB	Standard Iron Bar	DFP	Donevan, Fleischman & Petrich, O.L.S.
WIT	Witness Monument	P1	Metropolitan Toronto Condominium Plan 1408
O/U	Origin unknown	P2	Plan 64R-16561
MEAS	Measured		
E	East		
W	West		
N	North		
S	South		

METRIC :

Distances shown on this plan are in metres and can be converted to feet by dividing by 0.3048.

SURVEYOR'S CERTIFICATE :

I CERTIFY THAT:  
1 This survey and plan are correct and in accordance with the Surveys Act, the Surveyors Act and the Land Titles Act and the regulations made under them;  
2 The survey was completed on the 18th day of September, 2008.

25 SEP. 2008

*Helmut Piller*

date Helmut Piller  
reference number: 07-36-8472RP-00 Ontario Land Surveyor



H. Piller Corporation Ltd