

95 Prince Arthur Ave. #715  
\$439,000

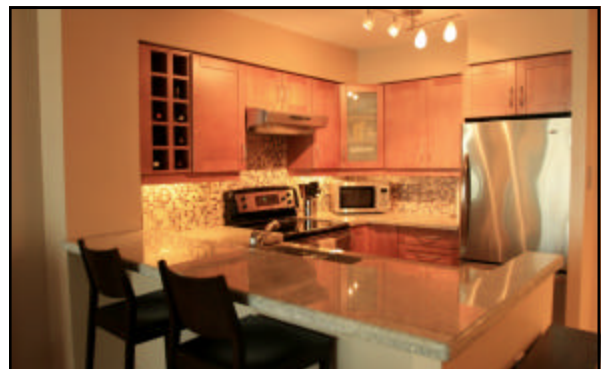

<b>Foyer</b>	2.97 x 2.18m	✎ Coat closet with mirrored sliding doors, porcelain ceramic tiled floors.
<b>Living Room</b>	6.55 x 3.51m	✎ Combined with Dining room, walkout to balcony through sliding glass doors, hardwood floors.
<b>Dining Room</b>	6.55 x 3.51m	✎ Combined with Living room, hardwood floors.
<b>Kitchen</b>	2.97 x 2.29m	✎ Renovated, granite countertops, breakfast bar, porcelain ceramic tiled floors. ✎ <b>Stainless Steel Appliances</b> ✎ Fridge, stove, hood, dishwasher.
<b>Master Bedroom</b>	4.57 x 3.05m	✎ French doors opening to den, hardwood floors, closet.
<b>Den/Solarium</b>	3.05 x 2.90m	✎ Skylight, hardwood floors.
<b>Bathroom</b>	1-4pc.	✎ Renovated, porcelain ceramic tiled floors,
<b>Laundry Room</b>		✎ Washer, dryer.

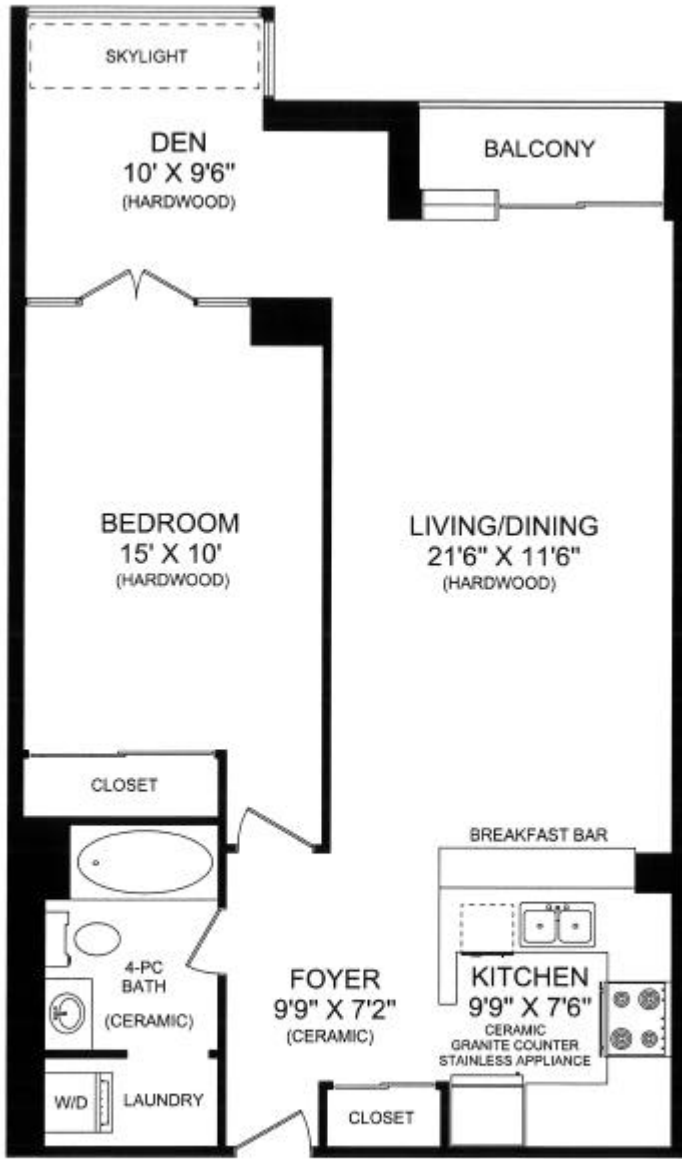



816 SQUARE FEET



TRUPLAN  
416 573 2096  
E & O.E.

Floor plan may not be 100% accurate.

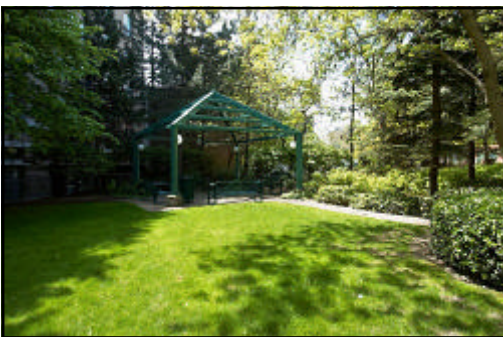

**FEATURING:** Extremely desirable building. Prestigious Annex/Yorkville address. Surrounded by lush gardens. 816 square feet. Large 1 bedroom unit + solarium. Renovated throughout. Hardwood floors. Open concept living/dining rooms. Balcony with unobstructed view. Upscale U shaped kitchen with high quality stainless steel appliances, granite counters & breakfast bar. Renovated bathroom, ensuite laundry, locker. 24 hour concierge, quaint rooftop BBQ & party room.

**LOCATION:** Prime Annex Condo. Minutes from Bloor street, subway, UofT and Yorkville.

**SCHOOLS:** Huron Street Junior PS, Jesse Ketchum Junior & Senior PS, Jarvis CI, Royal St. George's, Institute For Child Study, Taddle Creek Montessory, University of Toronto School, Waldorf School, George Brown College, University of Toronto, Ryerson University.

**PARKING:** 1 car parking (owned) P1 #4

**LOCKER:** 1 locker (owned) P2 #L96

**MAINTENANCE FEES:** \$480.27 Includes: heat ,hydro, water, common elements, building insurance, parking.

**TAXES:** \$2,491.71 (2010)

**INCLUSIONS:** Existing light fixtures, stainless steel fridge, stove, hood, dishwasher, washer, dryer.

**EXCLUSIONS:** Home theatre system and related components.

For Further information, please contact

**Ophira Sutton**

Sales Representative

**Sutton Group-Associates Realty Inc., Brokerage**

416-966-0300

[ophirasutton@rogers.com](mailto:ophirasutton@rogers.com)

[www.ophirasutton.com](http://www.ophirasutton.com)

This feature sheet is for marketing purposes only. All information is deemed reliable but not a warranty or representation as to its accuracy. It is subject to error, omissions, changes, prior to sale or other conditions. Seller pr agents shall not be held liable, Buyer responsible to verify all information. All above measurements are approximate and are given in meters except where stated. The information included in this feature sheet was collected from various sources.